

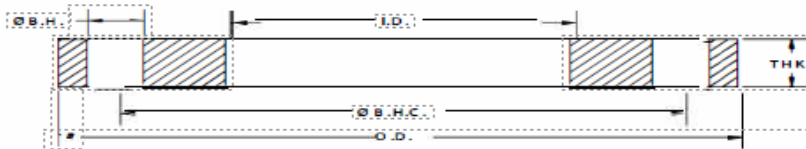

INDUSTRIAL CHOICE



1/2" Thick Stainless Steel Slip-on Flanges for Pipe

I.C. Part Number-SS304/SS316	Size	O.D.	I.D.	Ø B.H.C.	Ø B.H.	# B.H.	THK	Weight lbs
FLI/2-PL-IPS-50S4/S6	0.5	3.50	0.88	2.38	0.630	4	0.500	1.0
FLI/2-PL-IPS-.75S4/S6	0.75	3.88	1.09	2.75	0.630	4	0.500	1.3
FLI/2-PL-IPS-1S4/S6	1	4.25	1.36	3.13	0.630	4	0.500	1.7
FLI/2-PL-IPS-1.25S4/S6	1.25	4.63	1.70	3.50	0.630	4	0.500	2.3
FLI/2-PL-IPS-1.5S4/S6	1.5	5.00	1.95	3.88	0.630	4	0.500	2.5
FLI/2-PL-IPS-2S4/S6	2	6.00	2.44	4.75	0.750	4	0.500	3.0
FLI/2-PL-IPS-2.5S4/S6	2.5	7.00	2.94	5.50	0.750	4	0.500	4.0
FLI/2-PL-IPS-3S4/S6	3	7.50	3.57	6.00	0.750	4	0.500	4.7
FLI/2-PL-IPS-3.5S4/S6	3.5	8.50	4.07	7.00	0.750	8	0.500	5.5
FLI/2-PL-IPS-4S4/S6	4	9.00	4.57	7.50	0.750	8	0.500	6.4
FLI/2-PL-IPS-5S4/S6	5	10.00	5.66	8.50	0.875	8	0.500	7.2
FLI/2-PL-IPS-6S4/S6	6	11.00	6.72	9.50	0.875	8	0.500	8.4
FLI/2-PL-IPS-8S4/S6	8	13.50	8.72	11.75	0.875	8	0.500	11.4
FLI/2-PL-IPS-10S4/S6	10	16.00	10.88	14.25	1.000	12	0.500	14.6
FLI/2-PL-IPS-12S4/S6	12	19.00	12.88	17.00	1.000	12	0.500	21.6
FLI/2-PL-OD-14S4/S6	14	21.00	14.19	18.75	1.125	12	0.500	26.5
FLI/2-PL-OD-16S4/S6	16	23.50	16.19	21.25	1.125	16	0.500	31.0
FLI/2-PL-OD-18S4/S6	18	25.00	18.19	22.75	1.250	16	0.500	32.0
FLI/2-PL-OD-20S4/S6	20	27.50	20.19	25.00	1.250	20	0.500	37.5
FLI/2-PL-OD-22S4/S6	22	29.50	22.19	27.25	1.375	20	0.500	38.5
FLI/2-PL-OD-24S4/S6	24	32.00	24.19	29.50	1.375	20	0.500	49.0
FLI/2-PL-OD-26S4/S6	26	34.25	26.19	31.75	1.375	24	0.500	52.0
FLI/2-PL-OD-28S4/S6	28	36.50	28.19	34.00	1.375	28	0.500	54.0
FLI/2-PL-OD-30S4/S6	30	38.75	30.19	36.00	1.375	28	0.500	65.0
FLI/2-PL-OD-32S4/S6	32	41.75	32.19	38.50	1.625	28	0.500	70.0
FLI/2-PL-OD-34S4/S6	34	43.75	34.19	40.50	1.625	32	0.500	74.0
FLI/2-PL-OD-36S4/S6	36	46.00	36.19	42.75	1.625	32	0.500	81.0
FLI/2-PL-OD-38S4/S6	38	48.75	38.19	45.25	1.625	32	0.500	93.0
FLI/2-PL-OD-40S4/S6	40	50.75	40.19	47.25	1.625	36	0.500	97.0
FLI/2-PL-OD-42S4/S6	42	53.00	42.19	49.50	1.625	36	0.500	104.0
FLI/2-PL-OD-44S4/S6	44	55.25	44.19	51.75	1.625	40	0.500	111.0
FLI/2-PL-OD-46S4/S6	46	57.25	46.19	53.75	1.625	40	0.500	118.0
FLI/2-PL-OD-48S4/S6	48	59.50	48.19	56.00	1.625	44	0.500	124.0